

IX SERIES INSTALLATION INSTRUCTION

NOTICE: The IX family of products has multiple internal configurations and options. The IX unit may consist of dc protectors only, data protectors only, or dc and data protectors in multiple combinations. They can be used in an indoor or outdoor environment to protect data and dc twisted pairs.

CAUTION: Do not install during adverse weather conditions when the threat of lightning strike is possible. Connect this unit in the direction it is labeled. Each side of the unit has been labeled SURGE and PROTECTED for this purpose, and numbered 1 through 5 for each individual assembly. A reference label is located on the inside of the lid that provides a diagram correlating these numbers to their assembly and how that assembly is to be wired. Data assemblies are labeled + or -, DC assemblies are labeled +/- or GND, IG assemblies are marked Feed and Return. The preferred grounding method is via the 2 holes on the lid, the unit may be grounded through mounting to a plate or bulkhead panel if attached to an earth ground system.

RECOMMENDED INSTALLATION

1. Mount the unit with two 8-32 screws. Use the template to drill 3/16 clearance hole, or tap for 8-32.
2. Match proper grommet to cable diameter and insert cable.
For cable diameters .135" to .225", use grommet with small hole
For cable diameters .250" to .350", use grommet with large hole
Feed cable through grommet as shown; Silicone lubricant is provided to ease the insertion of cable to grommet.
Warning: Cutting the grommet to install connectorized cables may compromise the environmental seal. Additional sealing tape or adhesive may be required to assure a weather tight seal.
3. After connecting wires to terminal blocks, seat grommet securely in box channels. Attach spot ties to prevent pullout. If using shielded cable, the shield can be grounded as shown using the ring terminals and screws provided.
4. Be sure lid gasket is properly seated. Ensure lid mates with grommet. Secure lid using four (4) M4 screws, alternately tightening screws to bring lid down evenly.
5. Unit must be attached to Earth Ground. 5/8 on center attachment points on the lid and 1/4-20 screws are provided.

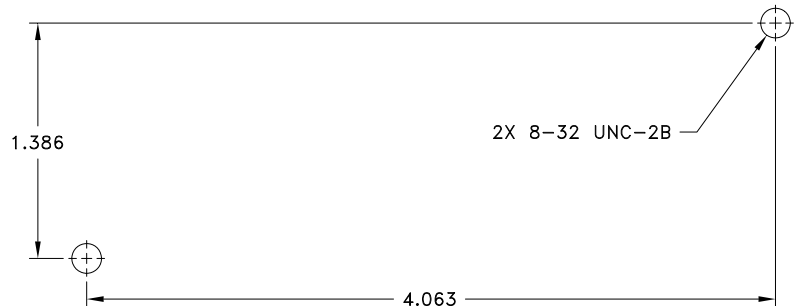
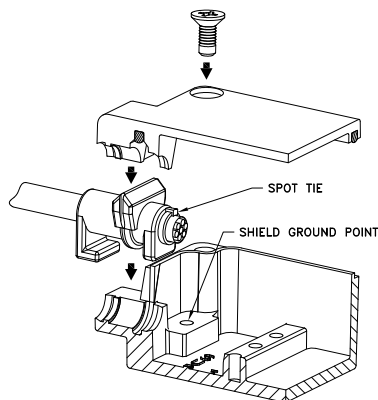

6. Specifications:
 - Wire gauge: 16-28 AWG
 - Wire strip length: 0.25"
 - Terminal block tightening torque: $2.21 \pm .25$ lbf-in. [0.25 N-m]
 - Lid screw tightening torque: 15 ± 1.5 lbf-in. [1.70 N-m]
 - Shield ground tightening torque: 6 ± 1 lbf-in [0.68 N-m]

IT IS VERY IMPORTANT THIS UNIT BE GROUNDED TO A LOW IMPEDANCE (LOW R AND LOW L) GROUND SYSTEM IN ORDER TO WORK PROPERLY.

WARNING- Do not connect during a storm! Do not connect when transmissions are occurring! Do not stay in an area that has operating equipment in an electrical storm!